



WILTCHER'S
STEIGENBERGER

BRUSSELS





WILTCHER'S

STEIGENBERGER



« LOUISE » PACKAGE

As of 10 attendees

- Meeting room rental
- Morning coffee break
- Business Buffet Lunch
Sandwiches, salads, quiches, soup & desserts
- Lunch Beverages
Soft drinks and water
- Coffee and tea after lunch
- Afternoon coffee break
- LCD projector, screen, flipchart,
pads and pens
- Water in room

HALF-DAY
FULL-DAY

€ 79.00 PER PERSON
€ 89.00 PER PERSON

« LEOPOLD » PACKAGE

As of 10 attendees

- Meeting room rental
- Morning coffee break
- Hot & cold buffet (as of 20 attendees)
or 3-course-lunch
- Lunch Beverages
Soft drinks and water
- Coffee and tea after lunch
- Afternoon coffee break
- LCD projector, screen, flipchart,
pads and pens
- Water in room

HALF-DAY
FULL-DAY

€ 89.00 PER PERSON
€ 99.00 PER PERSON



WILTCHER'S

STEIGENBERGER

SPOIL YOUR GUESTS EVEN MORE

Choose from the following list to upgrade your package
These options are available in addition to our meeting packages

Per person

Additional coffee break *	€ 5.00
Half-day coffee break	€ 5.00
Full-day coffee break	€ 10.00
Coffee and tea after lunch	€ 3.00
Mignardises after lunch	€ 3.00
1 glass of house wine per person during lunch	€ 6.00
1/2 bottle of house wine per person during lunch	€ 10.00
1 glass of sparkling wine per person	€ 8.00
Candy buffet during coffee break *	€ 4.00
Permanent soft drinks, orange & multi-fruits juices – Half-day	€ 6.00
Permanent soft drinks, orange & multi-fruits juices – Full-day	€ 9.00
Soft drinks during coffee break *	€ 3.00
Nespresso machine per coffee break *	€ 3.00
Nespresso machine half-day	€ 6.00
Nespresso machine full-day	€ 9.00
Fresh juices during coffee break *	€ 3.00
Flavored water during coffee break *	€ 2.00

*Note: If you would like your buffet to be served in less than 1 hour, we will foresee additional stations
Therefore extra fees will apply (for buffets as of 60 attendees)*

** Duration of a coffee break : 30 minutes maximum*





WILTCHER'S

STEIGENBERGER

« A LA CARTE » COFFEE BREAKS

Welcome Coffee*

Coffee, tea, water, orange & multi-fruits juices and pastries of the day
€ 6.00 per person

Coffee Break

In the morning:

Coffee, tea, water, orange & multi-fruits juices, fruits and pastries of the day

In the afternoon:

Coffee, tea, water, orange & multi-fruits juices, fruits and sweets of the day

Service at a set time *	€ 8.00 per person
Permanent service – Half-day	€ 12.00 per person
Permanent service – Full-day	€ 16.00 per person

Light Coffee Break

Coffee, tea and individual cookies
(Up to 60 attendees)

Service at a set time *	€ 5.00 per person
Permanent service – Half-day	€ 8.00 per person
Permanent service – Full-day	€ 10.00 per person

Soft Drinks Break

Soft drinks and orange & multi-fruits juices

Permanent service – Half-day	€ 8.00 per person
Permanent service – Full-day	€ 12.00 per person

** Duration of a coffee break: 30 minutes maximum*



WILTCHER'S
STEIGENBERGER

FLOOR PLANS & CAPACITIES



GROUND FLOOR



WILTCHER'S

STEIGENBERGER

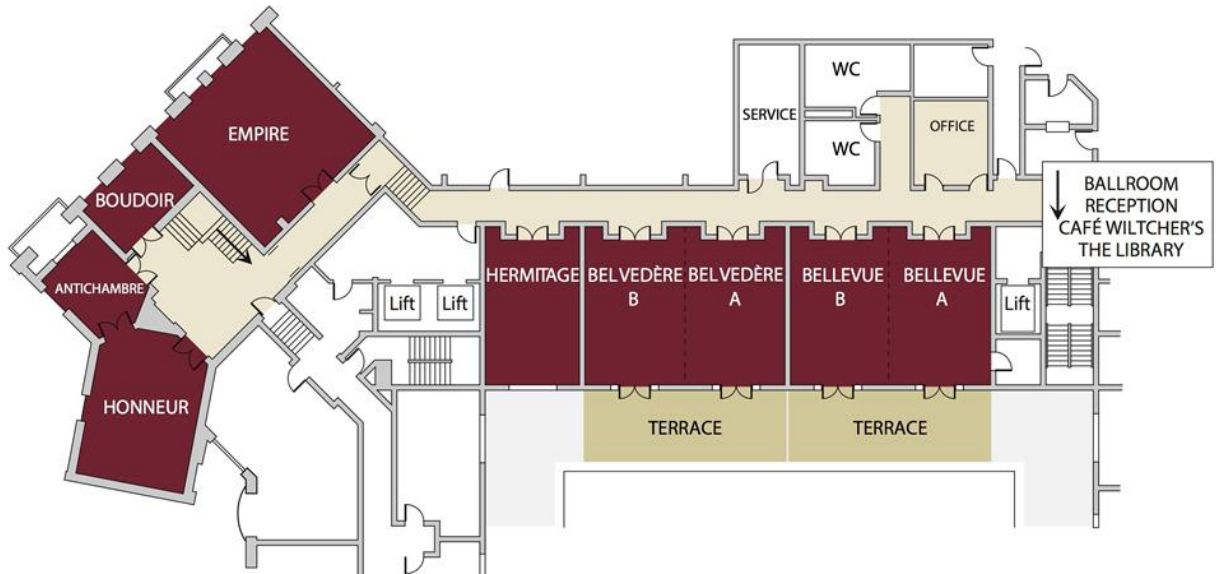

FIRST FLOOR

MEETING ROOMS	DAYLIGHT	AIR-CONDITIONING	FLOOR	MP	MEASUREMENTS	CELLING HT	THEATRE	CLASSROOM	U-SHAPE	CABARET	BOARDROOM	H-SQUARE	ROUND TABLE (12 PER TABLE) NO DANCE FLOOR	ROUND TABLE- (12 PER TABLE) DANCE FLOOR	COCKTAIL
Antichambre	•	•	1	19	3,7m*5,2m	3m	***	***	***	***	***	***	10	***	***
Ballroom		•	0	552	15m*36,8m	3,7m	600	350	96	301	***	150	528	480	600
Ballroom A		•	0	147	15m*9,8m	3,7m	150	72	36	63	***	50	132	84	150
Ballroom B		•	0	258	15m*17,2m	3,7m	250	150	48	119	***	80	240	192	250
Ballroom C		•	0	147	15m*9,8m	3,7m	150	72	36	63	***	50	132	84	150
Bellevue	•	•	1	72	9,8m*7,35m	2,75m	60	40	27	35	27	30	60	***	75
Bellevue A	•	•	1	36	4,9m*7,35m	2,75m	25	18	15	14	12	18	24	***	35
Bellevue B	•	•	1	36	4,9m*7,35m	2,75m	25	18	15	14	12	18	24	***	35
Belvedere	•	•	1	72	9,8m*7,35m	2,75m	60	40	27	35	27	30	60	***	75
Belvedere A	•	•	1	36	4,9m*7,35m	2,75m	25	18	15	14	12	18	24	***	35
Belvedere B	•	•	1	36	4,9m*7,35m	2,75m	25	18	15	14	12	18	24	***	35
Boudoir	•	•	1	16	3,2m*5m	3m	***	***	***	***	***	***	8	***	***
Empire	•	•	1	65	7,82m*8,25m	3m	50	24	20	35	22	24	48	***	60
Hermitage	•	•	1	37	5m*7,35m	2,75m	***	***	***	***	14	***	***	***	***
Honneur	•	•	1	53	6,8m*7,8m	3m	30	18	15	21	20	20	36	***	50
Foyer		•	0	95	7,8m*12,14m	3m	80	30	20	35	36	30	96	72	130
The Library	•	•	0	314	16,10m*19,5m	2,89m	***	***	***	***	***	***	Existing set up 110	***	300
Private dining	•	•	0	21	5,9*3,52m	2,89m	***	***	***	***	12	***	***	***	***
Terrasse	•		0	126	5,2*24,15m	***	***	***	***	***	***	***	Existing set up 56	***	130
Café Wiltcher's (mezzanine)	•	•	0	67	7,3*9,23m	3,1m	50	***	***	***	20	***	Existing set up 44	***	60
Café Wiltcher's (main level)	•	•	0	54	5,88*9,1m	3,3m	30	***	***	***	***	***	Existing set up 29	***	50
Café Wiltcher's (total)	•	•	0	121	13,28*9,1m	3,1m	***	***	***	***	***	***	Existing set up 73	***	150

Our spacious suites can also be privatized for exclusive events



WILTCHER'S

STEIGENBERGER



AUDIOVISUAL EQUIPMENT

Projectors

	<i>Price / Item / Day</i>
Projector LCD 2000 ANSI LUMENS	€ 400.00
Projector LCD 5000 ANSI LUMENS	€ 800.00
Projector LCD 8000 ANSI LUMENS	€ 2,000.00

Screens

Screen 2,40 x 1,80 m on frame	€ 85.00
Screen 3 x 2,25 m on frame	€ 100.00
Screen 3,60 x 2,70 m on frame	€ 130.00

Computer

Laptop	€ 220.00
--------	----------

Sound

Wired microphone	€ 30.00
Wireless microphone	€ 90.00
Headset microphone	€ 120.00
Speakerphone (15 pax)	€ 90.00
Sound system for Ballroom	€ 300.00
Sound system for Ballroom B, Library	€ 220.00
Sound system for Ballroom A & C, Foyer	€ 180.00
Sound system for Belvédère, Bellevue, Empire, Honneur	€ 130.00

Miscellaneous

Flipchart (markers and paper included)	€ 50.00
Laser pointer	€ 30.00
Laser pointer & Clicker	€ 60.00

• Other audio-visual equipment available via our external supplier upon request

Technical Assistance (per technician)

Weekdays and Saturday	€ 75.00 / hour
Sunday and bank holidays	€ 95.00 / hour



WILTCHER'S

STEIGENBERGER



ADDITIONAL INFORMATION

Music

Disc Jockey, live music, pianist are available upon request

Business Center

Open 24 hours every day

Decoration

Flower decoration is available from € 40.00 per table
Ice sculptures are available upon request

WiFi

Free wifi available everywhere in the hotel
Private network available upon request

Wiltcher's parking

600 parking spaces with direct access to the hotel – 24hrs a day

Fitness Gym

Located on first floor – Complimentary access for hotel guests

Cloakroom

Cloakroom attendant is available at € 32.00 / hour / attendant, with a minimum of 4 hours

VAT and service

VAT and service are included in all prices quoted in this brochure